

8800 Thinline Rocker Switches 10A 250Vac



- ▶ Ultra thin rocker switch
- ▶ Ratings up to 15A, 250Vac
- ▶ Single and twin gang
- ▶ Bezel sizes:
Single 21 x 9.5
Twin 21 x 15.5



10(6)A 250Vac T100
6(2)A 250Vac T100 5E4 (50,000 Operations)
Inrush 50A to EN60065:1998



UL CSA 15A 250Vac (Twin unit is 10A 250Vac)
UL CSA 125Vac 1/2hp
UL 100°C, file E45221, CSA file LR10990

In house test

10A 28Vdc



RoHS compliant

3mm contact gap.
 Technical data on pages 4 & 5.

H 8800 V A - - -

TERMINAL FUNCTION ROCKER BODY PRINT, COLOUR, ETC

▶ TERMINAL	▶ FUNCTION		▶ ROCKER
H 4.8 x 0.8		 Switches are ON when pressed over terminal 1	V Curved
	8800	 ON - OFF Single pole	
		 Switches are ON when pressed over terminals 1 or 3	
	8800/8800	 ON - OFF Twin (Single pole)	
T 3.5 x 0.8 Solder			



H8800VA ---
T8800VA ---



Actual Size

H8800VA ---
T8800VA ---



H8800V/H8800VA
T8800V/T8800VA



H8800V/H8800VA
T8800V/T8800VA

BODY

OPTIONS

A Single pole

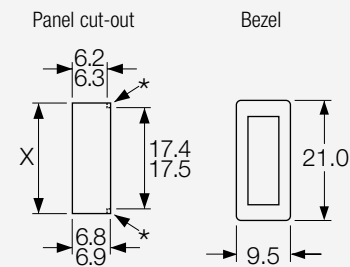

*Optional profile for orientation

A Single pole - Twin

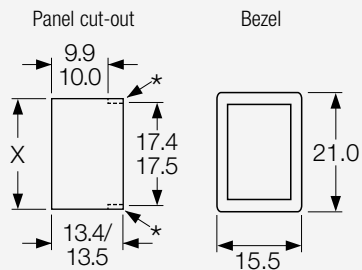

*Optional profile for orientation

Panel thickness	Dim X
0.75-1.24	19.1/19.2
1.25-1.99	19.3/19.4
2.00-3.00	19.7/19.8

Cut-outs must be punched in the direction of insertion

Finish

Matt finish only.

Colour

Call factory for custom colours.
A full range is available for large orders.

Legend printing

Select from the examples or call the factory for custom legends.

Dimensions (mm)

8800VA (H terminals shown)

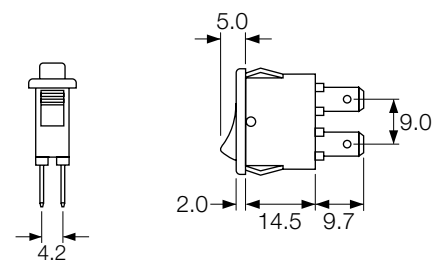

8800V/8800VA (H terminals shown)

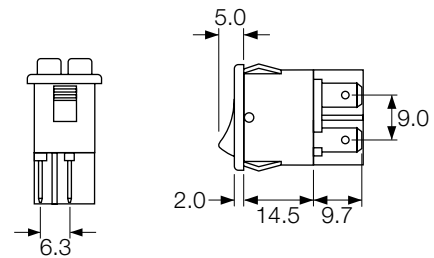

Examples of printing



CL132



CL133